

# AMG150 SERIES INDUSTRIAL GIGABIT 30/60/90W POE INJECTORS



## Industrial Ethernet Solutions

AMG's industrial PoE injectors provide 30W or 60/90W of power injection on one or two Gigabit Ethernet ports. Provided with dual power supply inputs and a fault relay as standard ensures maximum system reliability.



|                  |                  |                  |                      |             |                 |                   |
|------------------|------------------|------------------|----------------------|-------------|-----------------|-------------------|
|                  |                  |                  |                      |             |                 |                   |
| Gigabit up to x2 | Gigabit up to x2 | Temp -40°C~+75°C | Mounting DIN/Surface | PSU x2 Dual | Protection IP40 | NDA/TAA Compliant |

[ AMG150 1 & 2 Port Series ]

### OVERVIEW

Designed in a compact DIN rail or wall mount housing, the AMG150 series industrial Power over Ethernet (PoE) injectors are ideally suited for providing power to remote edge network devices.

Available in both IEEE802.3at 30W or IEEE802.3bt 60/90W they are suitable for powering the latest high powered PoE devices over a wide industrial operating temperature range.

The unique AMG dual active port PoE function enables the units to operate as standard single channel injectors where power is supplied out from a single port or provide PoE power out of both ports simultaneously allowing 2 devices to be powered.

Fitted with dual redundant power inputs and power failure alarm relay ensures maximum operating reliability and the highest levels of performance.

A wide range of models are available to suit all design requirements.

PSUs need to be ordered separately.

### FEATURES

- Compact size – ideal for confined spaces, including camera poles and roadside cabinets
- -40°C to +75°C temperature maintains performance in extreme conditions
- Plug & Play – no need for any user configuration
- DIN rail mountable – quick to install and remove for maintenance
- Dual PoE ports support 2 PD devices simultaneously
- RJ45 ports support all 10/100/1000Mb speeds
- Dual redundant power inputs with fault relay
- Supports 15W, 30W, 60W and 90W PoE
- Auto-Negotiation (802.3u) – automatically determines the best connection speed
- Designed in the USA & UK. Manufactured in the United Kingdom
- AMG Lifetime Support Warranty

# Specifications.

## Standards.

|             |              |
|-------------|--------------|
| IEEE802.3i  | 10Base-T     |
| IEEE802.3u  | 100Base-TX   |
| IEEE802.3ab | 1000Base-T   |
| IEEE802.3af | 15W PoE      |
| IEEE802.3at | 30W PoE+     |
| IEEE802.3bt | 60 & 90W PoE |
| IEEE802.3x  | Flow Control |

|               |                |
|---------------|----------------|
| Jumbo Frames  | 9.2Kbytes      |
| Address Table | 2K MAC Entries |

## Interface.

|                |   |
|----------------|---|
| LED Indicators | 2x Power<br>RJ45 Link/Activity<br>PoE   |
| RJ45 Ports     | 2x 10/100/1000T(X) RJ45<br>with Auto MDI/MDI-X and<br>1.5 kV Isolation Protection |
| Power/Relay    | 1x 6 pin removable terminal<br>block with locking screws                          |

## Power.

|                   |  |
|-------------------|--|
| Power Inputs      | 2  |
| Operating Voltage | 50-56V <sub>DC</sub> (30W PoE Models)<br>52-56V <sub>DC</sub> (90W PoE Models) |
| Power Consumption | 2W Max (without PoE Load)  |
| PSE Modes:        |  |
| 30W Models        | Mode A   |
| 60/90W Models     | Mode A, Mode B   |
| Protection        | Reverse Polarity,<br>Overload Current  |
| Fault Relay       | Form A<br>60V @ 2A Max   |

## Surge Protection.

|                       |  |
|-----------------------|--|
| IEC 61000-4-2 (ESD)   | ±30kV Contact Discharge<br>±30kV Air Gap Discharge |
| IEC 61000-4-4 (EFT)   | 40A (5/50ns)                                       |
| IEC 61000-4-5 (Surge) | 20A (8/20µs)                                       |

## Packaging.

|                 |   |
|-----------------|---|
| Shipping Weight | 0.60kg / 1.32lb   |
| Dimensions      | (W x D x H)<br>220 × 170 × 40 mm<br>8.66 × 6.69 × 1.57 in |

## Mechanical.

|                           |  |
|---------------------------|--|
| Housing                   | Anodised Aluminium                                       |
| Dimensions:               | (W x D x H)<br>36 × 88 × 107 mm<br>1.42 × 3.46 × 4.21 in |
| (Excluding Wall Brackets) |  |
| IP Rating                 | IP40   |
| Installation              | Wall Mount or DIN-Rail                                   |
| Weight                    | 0.45kg / 0.99lb  |

## Environmental.

|                  |   |
|------------------|---|
| Operating Temp.  | -40 to +75°C / -40 to +167°F                                      |
| Storage Temp.    | -40 to +85°C / -40 to +185°F                                      |
| Humidity         | 5% to 95% (non-condensing)  |
| MTBF             | 2,332,497 hours   |
| MTBF Standard    | Telcordia SR-332 GF 30°C  |
| Heat Dissipation | 109 BTU/h (30W PoE)<br>212 BTU/h (60W PoE)<br>314 BTU/h (90W PoE) |
| Cooling          | Passive Cooling   |
| Noise Level      | 0 dBA   |

## Regulatory.

|               |   |
|---------------|---|
| Safety        | IEC/EN 62368-1  |
| EMI           | EN 55032 Class A<br>CISPR 32<br>FCC Part 15B Class A  |
| EMS           | EN 61000-4-2 (ESD)<br>EN 61000-4-3 (RS)<br>EN 61000-4-4 (EFT)<br>EN 61000-4-5 (Surge)<br>EN 61000-4-6 (CS)<br>EN 61000-4-8 (PFMF) |
| Shock         | IEC 60068-2-27  |
| Free Fall     | IEC 60068-2-32  |
| Vibration     | IEC 60068-2-6   |
| Environmental | Reach<br>RoHS<br>WEEE   |
| Supply Chain  | NDAA & TAA Compliant  |

Designed to meet NEMA TS2 & EN 50121-4

# Application Diagram.

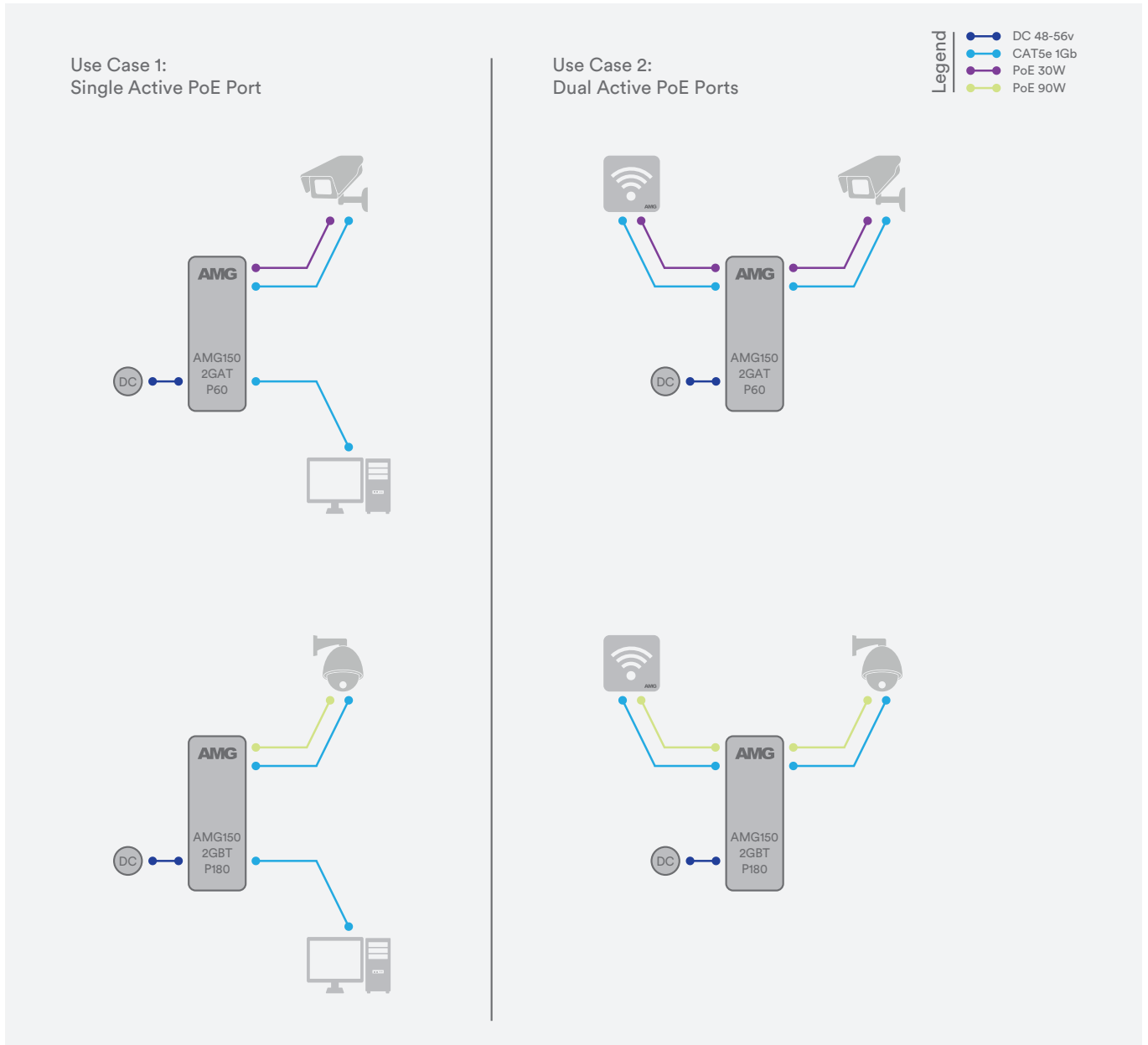

# Part Numbers.

---

## Industrial PoE Injectors

|                  |  |
|------------------|--|
| AMG150-2GAT-P60  | 2 x 10/100/1000BaseT(x) RJ45 with 30W PoE+, Can Be 1x In & 1x 30W Out or 2x 30W Out    |
| AMG150-2GBT-P180 | 2 x 10/100/1000BaseT(x) RJ45 with 60/90W PoE+, Can Be 1x In & 1x 90W Out or 2x 90W Out |

## Included Accessories.

---

|                        |  |
|------------------------|--|
| DIN Rail Adapter       | Rear Mounted Metal DIN Rail Clip & Screws For DIN Rail Mounting AMG150 Series Products |
| Wall Mounting Brackets | 2x Wall Mounting Brackets & Screws For Wall / Surface Mounting AMG150 Series Products  |

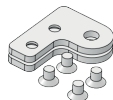
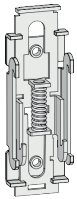

## Recommended PSUs.

---

|                 |   |
|-----------------|---|
| AMGPSU-I48-P60  | DIN-Rail Mounting Industrial Grade PSU, -40 to +70°C, 43-56VDC, 60W   |
| AMGPSU-I48-P120 | DIN-Rail Mounting Industrial Grade PSU, -40 to +70°C, 47-53VDC, 120W* |
| AMGPSU-I48-P240 | DIN-Rail Mounting Industrial Grade PSU, -40 to +70°C, 48-53VDC, 240W* |

\*Also available with no exposed mains terminals and direct IEC input. Order with -IEC at the end of the part code (e.g. AMGPSU-I48-P120-IEC)

## Optional Accessories.

---

|         |   |
|---------|---|
| AMG2035 | Side Mounted Wall Bracket Adapter Kit For DIN Rail Mounting AMG150 Series Products In Depth Restricted Installations. Adapter Kit Can Be Extended Using The Included Extension Kit To Also Mount A DIN Rail Power Supply Up To 480W |
|---------|---|

In a continuing effort to improve and advance technology, product specifications are subject to change without notice. Please visit [www.amgsystems.com](http://www.amgsystems.com) for the latest product specifications.

Proud to be a British  
Manufacturer 